

## **presentation : cruise control (RVV) and speed limiter (LVV)**

### **1 Glossary**

RVV: cruise control.

LVV: speed limiter.

#### **1.1 Cruise control**

The cruise control (RVV) system holds the vehicle speed at a reference value programmed by the driver.

The driver can take the following actions

:

- select or deselect the cruise control
- adjust the reference value by increasing or decreasing it when the cruise control is active
- activate the cruise control at a reference value which is equal to the current speed of the vehicle
- activate the cruise control at the stored reference value
- deactivate the cruise control
- bypass the programmed speed by depressing the accelerator pedal

**N.B. :** Cruise control only operates from 40 km/h.

#### **1.2 Speed limiter**

The speed limiter (LVV) system prevents the vehicle speed programmed by the driver from being exceeded.

The driver can take the following actions

:

- select or deselect the speed limiter
- adjust the reference value by increasing or decreasing it before activating the speed limiter function
- adjust the reference value by increasing or decreasing it when the speed limiter is active
- activate the speed limiter at the stored reference value
- deactivate the speed limiter
- bypass the programmed speed by depressing the accelerator pedal

### **2 Switching module under the steering wheel**

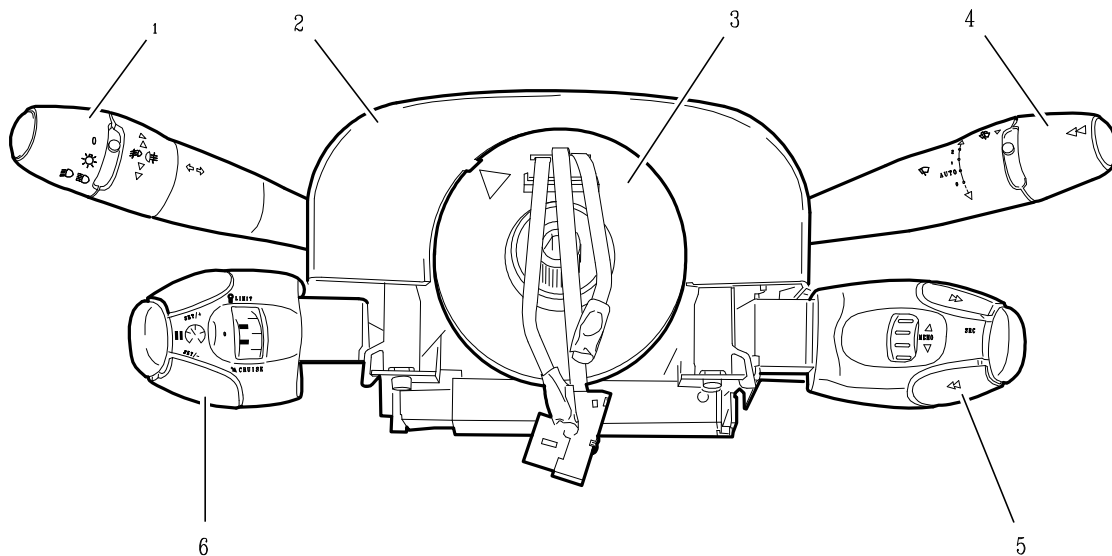

Fig. d4ap05dd.

- Fig. : 1 -

The switching module under the steering wheel is a monoblock unit which groups the following components :

- ( 1 ) :  
the lighting switch
- ( 2 ) :  
the switch unit mounting
- ( 3 ) :  
the rotary contact
- ( 4 ) :  
the wiper switch
- ( 5 ) :  
the audio system control (depending on version)
- ( 6 ) :  
the cruise control and speed limiter selector (depending on version)

The switching module under the steering wheel is the man/machine interface for for the radio controls, cruise control, wipers and lighting.

The switching module under the steering wheel retransmits the driver's actions to the BSI 1 via the multiplexed BODY CAN.

The switching module under the steering wheel also assures the following functions

:

- control of the buzzer incorporated in the stalk support in relation to the sound requests transmitted by the BSI 1

- reception of the HF messages coming from the plip and from the under-inflation transmitters
- communication with the transponder for the coded immobiliser
- retransmitting the information coming from the steering wheel angle sensor

### 3 Cruise control and speed limiter selector

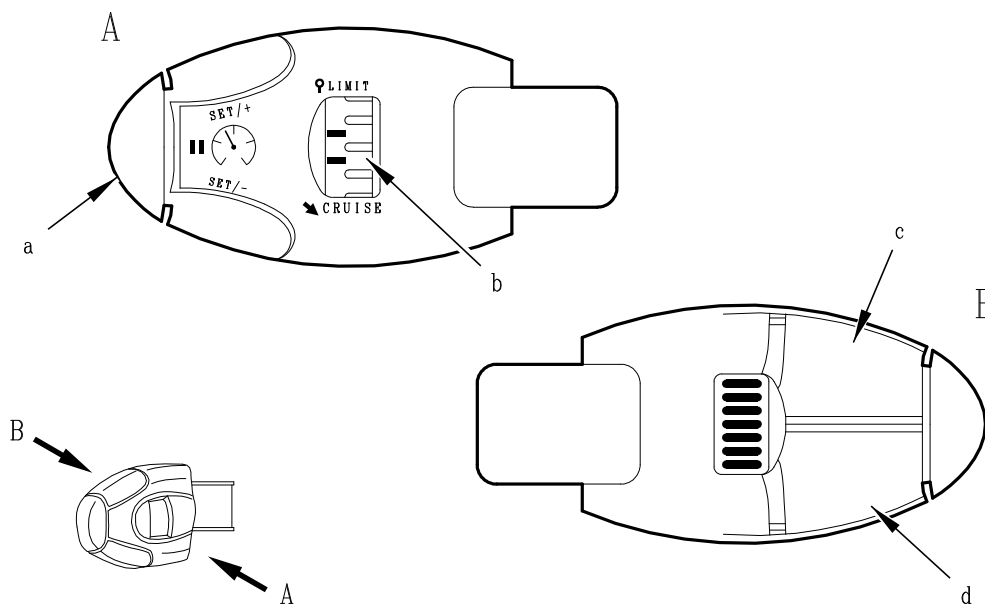

Fig. d4ap05fd.

- Fig. : 2 -

A.	Cruise control or speed limiter activation/deactivation button.
B.	3 -status multifunction control: select cruise control / deactivate / select speed limiter.
C.	Increase the speed reference value or set the speed reference value to the current speed.
D.	Decrease the speed reference value or set the speed reference value to the current speed.

**N.B. :** To facilitate use, both during the day and at night, the multifunction control has two references which are both visible when in the neutral position .

When one of the functions is selected, only the reference for the selected function remains visible.

## 4 Control of the cruise control and speed limiter functions

### 4.1 Cruise control

Initial status.	Control.	Final status.	Action.
0.	Position on CRUISE.	Cruise control on standby.	Selects the cruise control function.
Cruise control on standby (CRUISE).	Brief press on + or -.	Cruise control active.	The stored speed is displayed as the reference speed.
Cruise control active (CRUISE) with exceeding of the speed by action on the accelerator pedal.	Brief press on + or -.	Cruise control still active.	The stored speed is displayed as the reference speed.
Cruise control active (CRUISE) without exceeding of the speed by action on the accelerator pedal.	Brief press on + or -.	Cruise control active.	Progressive increasing or decreasing of the reference speed in steps of 1 km/h or 1 mph.
Cruise control active (CRUISE).	Extended press on + or -.	Cruise control active.	Progressive increasing or decreasing of the reference speed in steps of 5 km/h or 5 mph.
Cruise control active (CRUISE).	Press on deactivation / activation.	Cruise control deactivated / activated.	Deactivates the cruise control or activates the cruise control at the stored speed.
Cruise control deactivated / activated.	Position on 0.	Deactivation of the cruise control.	Exit from the cruise control, loss of the reference speed.

### 4.2 Speed limiter

Initial status.	Control.	Final status.	Action.
0.	Position on LIMIT.	Speed limiter on standby.	Selects the speed limiter function.
Limiter on standby	Brief press on + or -.	Speed limiter on	Progressive increasing or

(LIMIT).		standby.	decreasing of the reference speed in steps of 1 km/h or 1 mph.
Limiter on standby (LIMIT).	Extended press on + or -.	Speed limiter on standby.	Progressive increasing or decreasing of the reference speed in steps of 5 km/h or 5 mph.
Speed limiter on standby.	Press on activation / deactivation.	Limiting of the vehicle to the reference speed.	The vehicle cannot exceed the speed limiter reference value.
Limiter active without exceeding of the point of resistance.	Brief press on + or -.	Speed limiter active.	Progressive increasing or decreasing of the reference speed in steps of 1 km/h or 1 mph.
Limiter active without exceeding of the point of resistance.	Extended press on + or -.	Speed limiter active.	Progressive increasing or decreasing of the reference speed in steps of 5 km/h or 5 mph.
Speed limiter active.	Exceeding of the accelerator pedal point of resistance.	Speed limiter temporarily deactivated.	Exit from the speed limiter.
LIMIT.	If press on deactivation / activation.	Speed limiter deactivated / activated.	Deactivates or activates the speed limiter at the stored reference value.
LIMIT.	Position on ( 0 ).	Deactivation of the speed limiter.	Exit from the speed limiter if active, reference speed stored.